

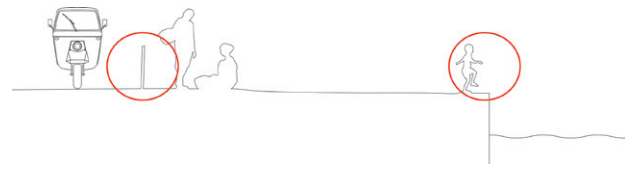

SCALE 1:200

PROTECTION against potential hazardous situations is critical to ensure usability and maintenance of any public space.

In order to establish the sense of **SAFETY**, we aimed to improve the border designs by enhancing security measures and protection against traffic and water edge.



Current site conditions offer little or no barrier against environmental hazards. For instance, vendors are exposed to vehicular traffic with no protection, while the water edge has large areas of overgrown and no safety border.



1

The proposed plinth system acts as a safety barrier between pedestrians and vehicular traffic, providing separate platforms for daily interactions. These platforms also can be used by local vendors and customers on market days, allowing exchange of goods and socialization.

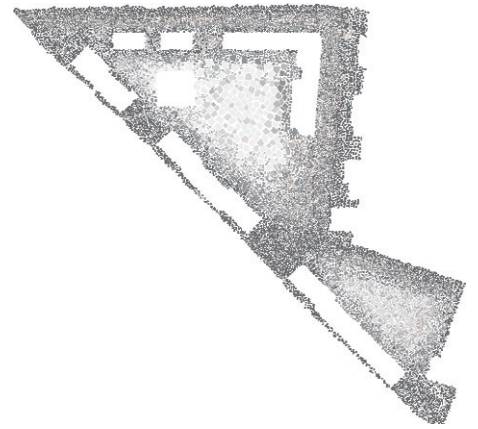

CENTRAL SPACE

Lightest in colour
Sizing approx. 65-80cm

BORDERS

Darkest in colour
Sizing approx. 35-45cm

TRANSITION

Fading zones
Sizing approx. 15-20cm



2

Against the water edge, a heightened barrier of 60cm with sitting platforms prevents potential falling hazards. While acting as a safety border along the temple tank, the platforms with varying heights provide seating areas and drying surfaces for food and clothing.

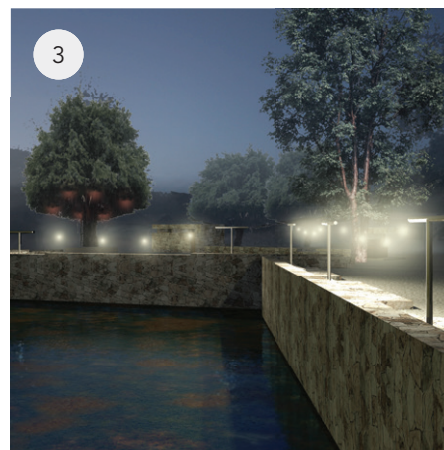

3

After dark, lights alongside the water barrier can greatly enhance a sense of security for late passerbys, reducing possibilities of criminal activities and disrespectful behaviours nearby the Nageshwar temple.