

DESIGN CONCEPTS

The design was conceived through three overarching design concepts. First one being to connect the museum island and the vikingship museum, while at the same time creating a clear division between the free (the museum island) and the paid area (the vikingship museum). The second being adding services and activities for the locals of Roskilde. Last but not least how the viking boat Havhingsten informed and shaped the construction and form of the buildings.

CONNECTING THE MUSEUM ISLAND AND THE OLD MUSEUM

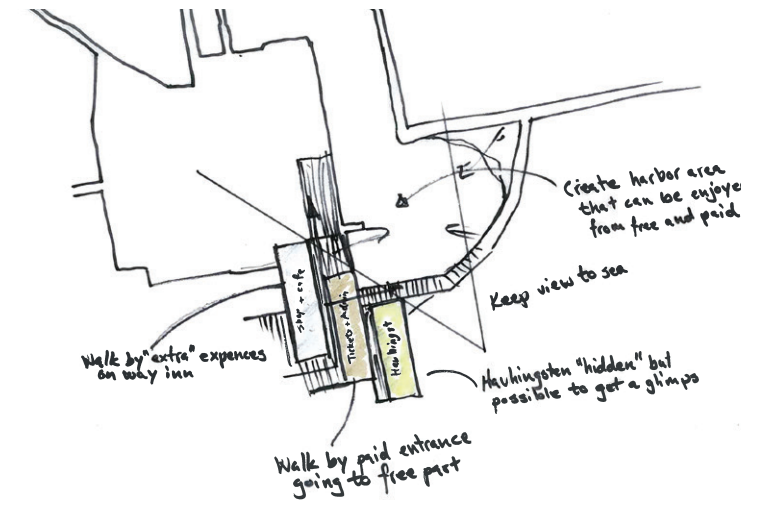
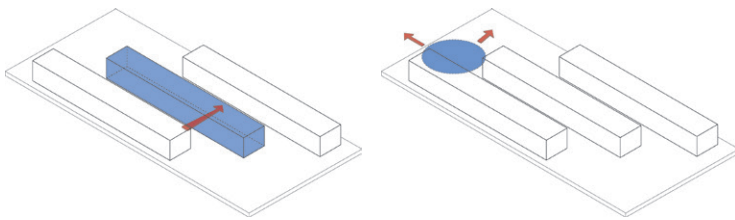
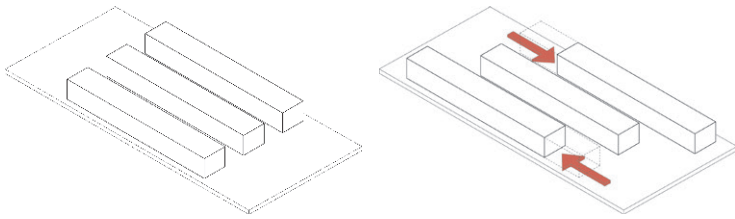
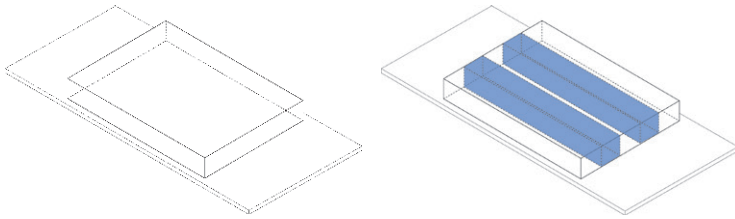

Not wanting to create a completely new element to the site nor one that related only to either the vikingship museum or the museum island, both were used as inspiration for the visitor center. To begin, instead of making one big volume the building was divided in three with the different functions clearly divided. The buildings were then shifted, creating more of a divide. Finally, the structure was extended between the building volumes to make it obvious that despite being separate buildings, they are a part of the same building complex.

The middle building becomes a "wall" separating the free areas from the paid. At the same time however, it is the gateway and the entrance to the paid area, with ticket office, booking and other activities associated with the paid area/vikingship museum.

An open space is created at the end of the buildings, providing visitors with good view of both the museum island and the vikingship museum.

The buildings are placed so that visitors both arrive and leave through the visitor center whether they are going to enjoy the free part, the paid part, or both.

FOR THE LOCALS OF ROSKILDE

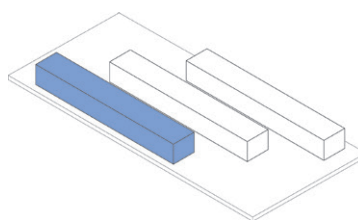
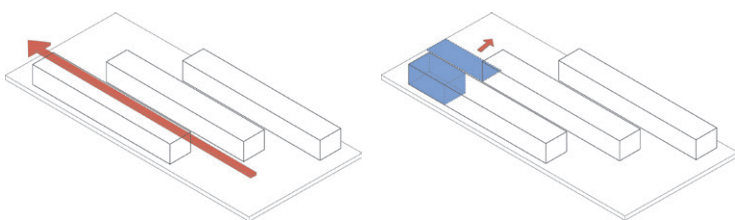

The western most building and middle building create a public path that can also be accessed when the rest of the complex is closed.

At the northern most end of the open area and a cafe in the building has a great view of the water and the vikingship museum that can be enjoyed by both locals and tourists alike.

The program being divided into separate buildings, allows for all additional economic activities to be situated in a building of its own that can operate also when the museum is closed and cater to the locals of Roskilde.

CONSTRUCTION

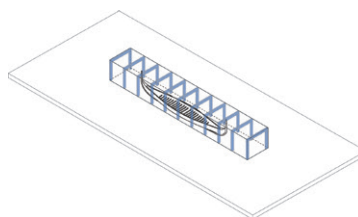
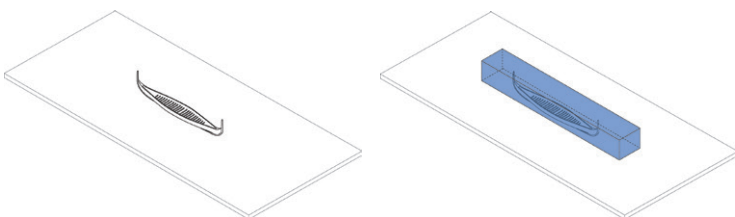

The shape of the building volumes developed from the requirements for house for "Havhingsten". This long slender shape was then implemented in all three buildings. At the same time the structure took on a simple system perpendicular to the long shape and at regular intervals like that in a boat.